

SmartView



Features

- Provides HMI IDE Software: Creator
- Supports Active M2M Transmission Mechanism: MQTT
- Makes connectivity for the "internet of things" devices easily.
- 7"/8.4"/10.4"/12.1"/15" LCD
- Resolution: 800 x 480 ~ 1024 x 768
- Resistive Touch Panel
- NEMA 4/IP65 Compliant Front Panel
- Operating Temperature: -10 ~ +60 °C



Introduction

The **SmartView** series of devices from ICP DAS combines a RISC-based CPU board, a TFT LCD touch screen and a ruggedized flat panel PAC, and includes a wide range of software, such as HMI and MQTT, which are perfect for a variety of control and HMI applications. The **SmartView** series provides a variety of connection options, including Gigabit Ethernet, RS-232 and RS-485 ports. The operating system is pre-installed in the onboard Flash memory, and Remote I/O expansion is available using ICP DAS Ethernet I/O modules and RS-485 I/O modules. The SmartView series is designed for panel-mount installation. The front panel is NEMA 4/IP65 rated, meaning that it can withstand sprayed water, humidity, and extreme dust, and can be operated over a wide ambient temperature range of -10°C to +60°C. The fan-less design provides the ultimate in reliability with no moving parts.



SmartView Panel PAC

Model	LCD	Flash	SDRAM	Memory Expansion	Ethernet	I/O slot	COM port
SV-2201	7" (800 x 480)	512 MB	512 MB	microSD	1	-	2
SV-3201	8.4" (800 x 600)			SD			
SV-4201	10.4" (800 x 600)						
SV-5201	12.1" (800 x 600)						
SV-6201	15" (1024 x 768)						

■ Provides Creator: Powerful HMI IDE Software

Creator is a professional development toolkit especially designed for the **SmartView** (or HA-401) series of devices produced by ICP DAS. Creator can be used to integrate several commonly used PLC communication protocols, providing rich and flexible object editing tools that allow easy navigation and adjustment of window management, repeated import and export of data in order to shorten the development process, simple uploading or updating of **SmartView** (or HA-401) projects using the built-in TCP transport, and the construction of control systems, ranging from a small and simple local control/monitoring application to management systems for large buildings, factories, and engine rooms, etc.

The **Creator** also supports "Internet of Things" transmission "MQTT", and I/O status simulation in designing process. Combined with these features, **Creator** can dramatically save development time and make the **SmartView** development more efficiently.

Creator Features:

- Supports Commonly Used PLC Communication Protocols
- Easy to Create HMI Projects Without the Need for Complex Coding
- Diverse Range of HMI Objects and Functions: Alarm, Schedule, Recipe, Data Log, Macro...
- Update Projects via Ethernet
- Supports MQTT
- Supports Online/Offline Simulation
- Supports Multiple Languages: Traditional Chinese/Simplified Chinese/English
- Provides 36 Macro Commands for Logic Operations or Controls

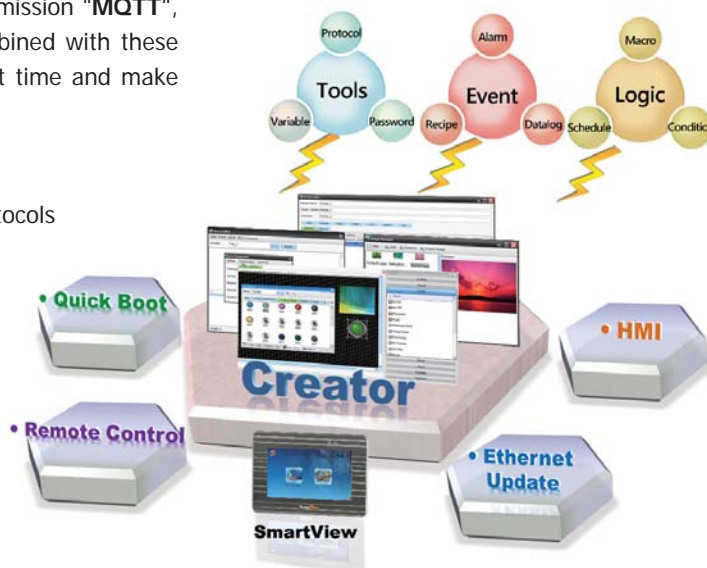

■ Supports MQTT: Active M2M Transmission Mechanism

MQTT is a method of **Machine to Machine (M2M)** communication by writing and retrieving application-specific data (messages) to and from queues, without having a private, dedicated connection to link them. It simplifies and accelerates the integration of diverse applications data between SmartView under assured, secure and reliable exchange of information circumstance. Using MQTT in SmartView not only dramatically simplifies the creation and maintenance of Industrial application but also makes connectivity for the "internet of things" devices easily.

MQTT Features:

■ Rapid, Seamless Connectivity

Rapid, seamless connectivity of information with a single, robust and trusted messaging backbone for dynamic heterogeneous environments.

■ Secure, Reliable Message Delivery

Secure, reliable message delivery that preserves message integrity and minimizes risk of information loss.

■ High-performance Deployment

High-performance and scalable message transfer to meet the demands of today's enterprise and beyond.

■ Simplified Management and Control

Simplified management and control for better control and usability.

■ Cost Effective

Cost effective of ownership by reducing cost of integration and accelerating time to deployment.



Applications

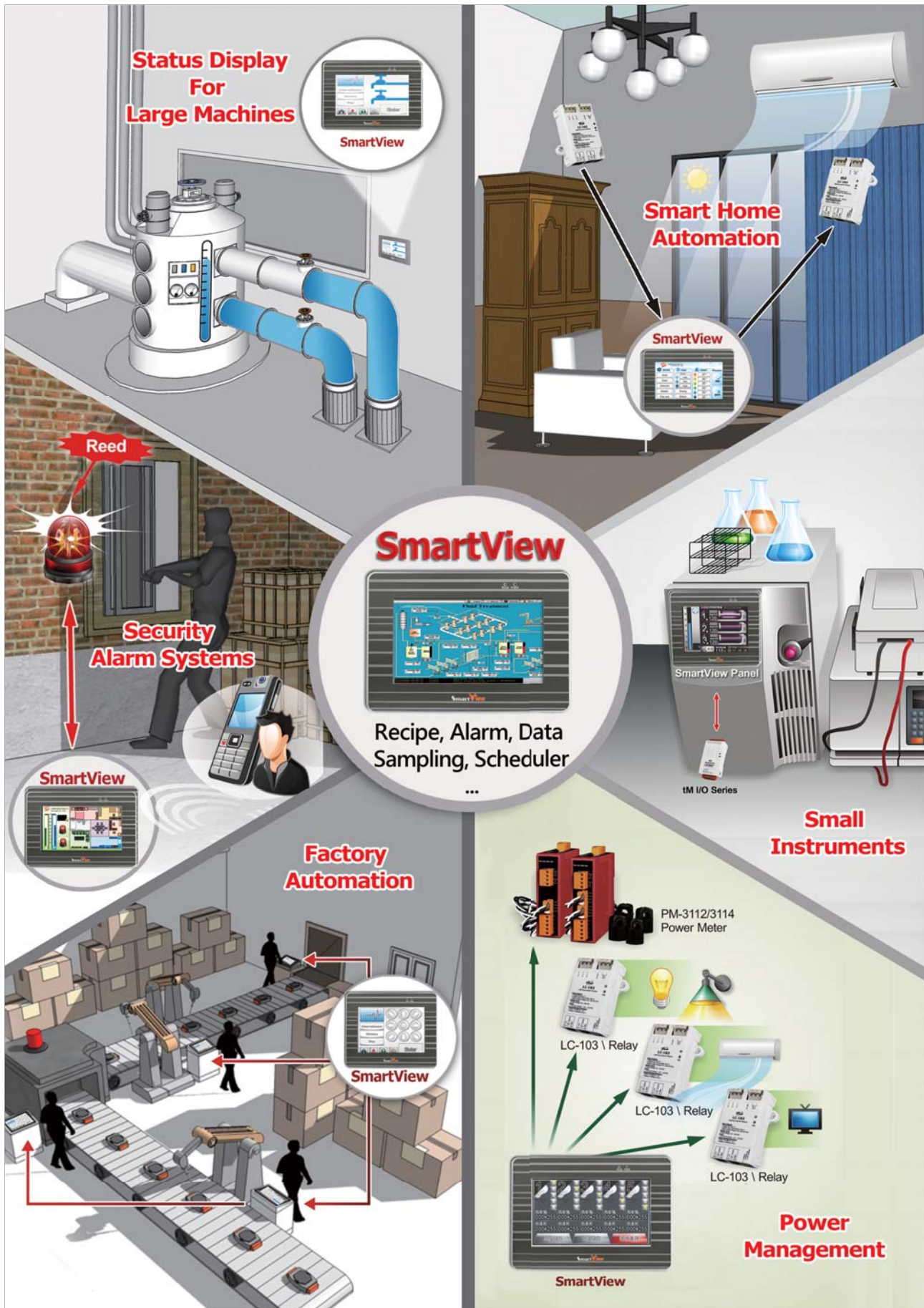

Specifications

Models	SV-2201	SV-3201	SV-4201	SV-5201	SV-6201
Development Software					
Creator	Creator is an HMI Integrated Development Environment (IDE) software toolkit for designing the SmartView Panel PC				
LCD Display					
Size	7" (16:9)	8.4" (4:3)	10.4" (4:3)	12.1" (4:3)	15" (4:3)
Resolution	800 x 480	800 x 600			1024 x 768
Brightness (cd/m2)	400				
Contrast Ratio	500 : 1				
LED Backlight Life (hrs)	20,000	50,000			
Touch Panel	4-wire, resistive type; Light transmission: 80%	5-wire, resistive type; Light transmission: 80%			
LED Indicator	2 (PWR, Run)				
System Software					
OS	Linux				
CPU Module					
CPU	RISC-based				
SDRAM	512 MB				
MRAM	128 KB				
Flash	512 MB				
Memory Expansion	microSD socket (support up to 32 GB)	SD socket (support up to 32 GB)			
EEPROM	16 KB				
RTC (Real Time Clock)	Yes				
Hardware Serial Number	Yes, 64-bit Hardware Serial Number				
Rotary Switch	Yes (0~9)				
DIP Switch	-	Yes (6 bit)			
Communication Interface					
Ethernet	1x RJ-45, 10/100/1000 BaseTX				
USB 2.0 (host)	2				
COM1	RS-232/485; 2500 VDC isolated	-	RS-232/485 (DB9 connector); 2500 VDC isolated		
COM2	RS-232/485 ; 2500 VDC isolated				
COM3	-	RS-485 (Terminal Block, Data+, Data-); 2500 VDC isolated			
Audio	Earphone-out				
Mechanical					
Dimensions (W x H x D, mm)	213 x 148 x 44	249 x 207 x 64	291 x 229 x 54	324 x 255 x 64	381 x 305 x 63
Panel Cut-Out (W x H, mm)	197 x 133, ± 1	235 x 193, ± 1	277 x 215, ± 1	310 x 241, ± 1	362 x 286, ± 1
Installation	Panel Mounting, VESA (75 x 75) Mounting				
Ingress Protection	Front Panel: NEMA 4 /IP65				
Environment					
Operating Temperature	-10 ~ +60°C				
Storage Temperature	-20 ~ +70°C				
Ambient Relative Humidity	10 ~ 90% RH (non-condensing)				
Power					
Power From Terminal Block	Yes, +12 ~ +48 VDC				
Power from PoE	Yes, IEEE 802.3af				
Isolation	1 kV				
Consumption	6 W	7.5 W	13 W	14 W	16 W

■ Dimensions

SV-2201

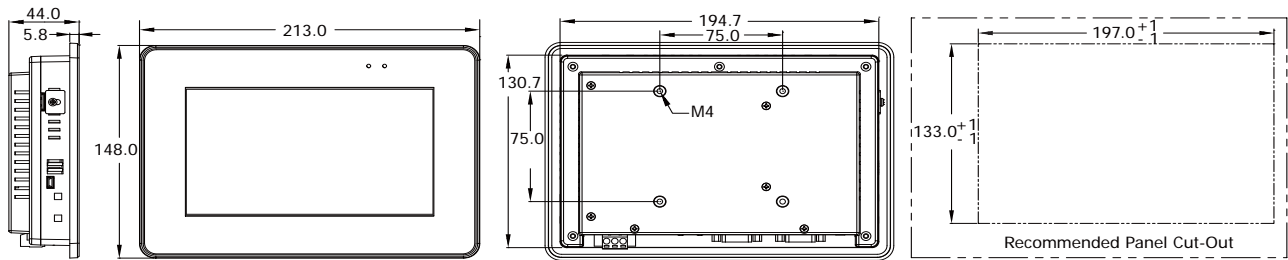

SV-3201

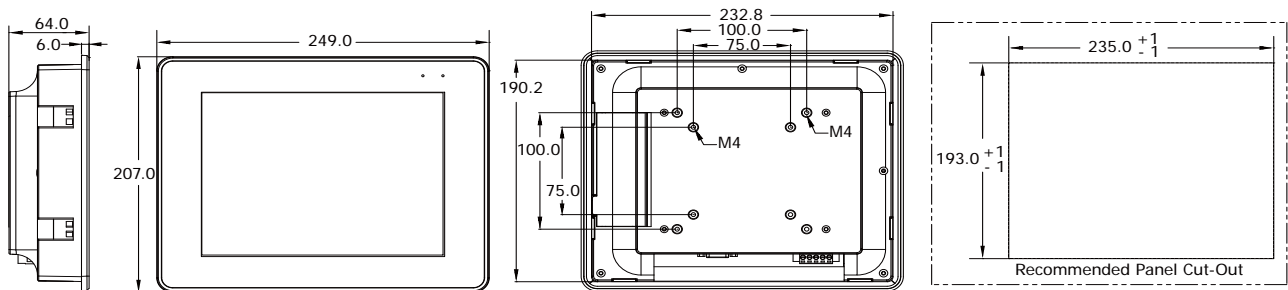

SV-4201

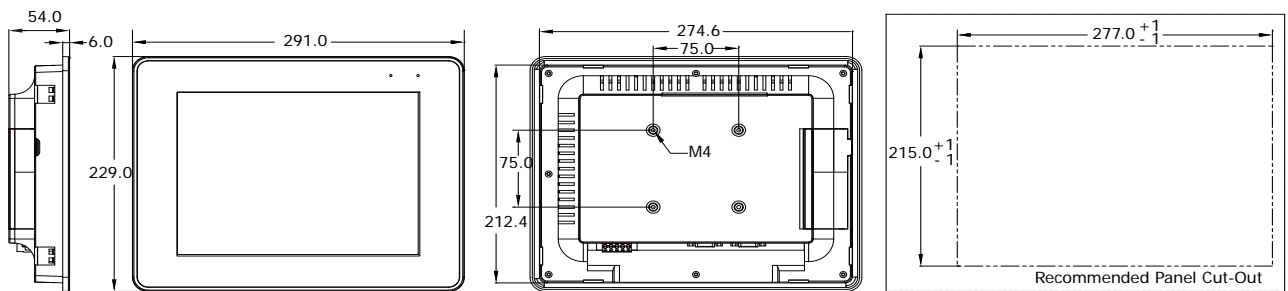

SV-5201

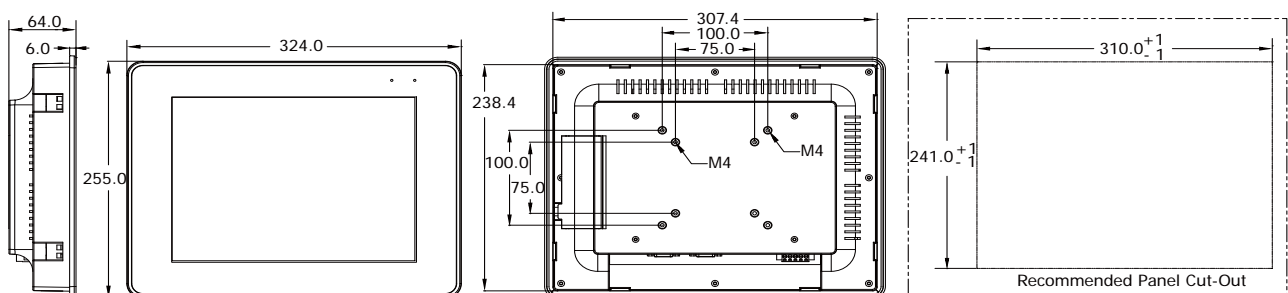

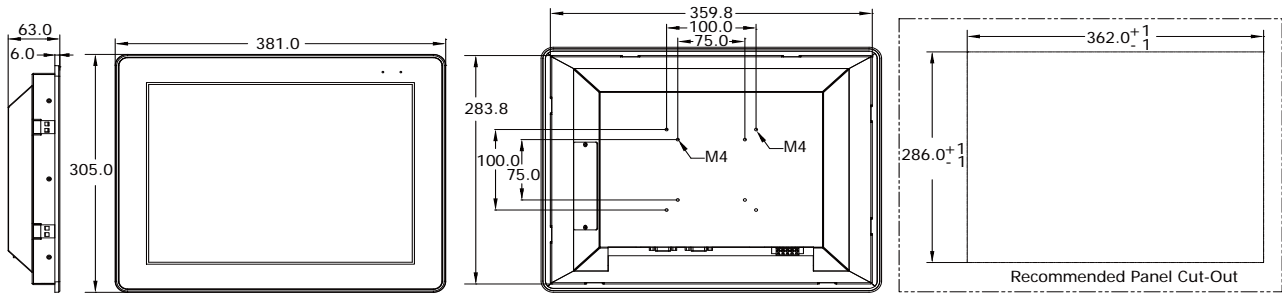
SV-6201**Appearance****SV-2201**

microSD Socket



Rotary SW.

7" LCD Touch Panel

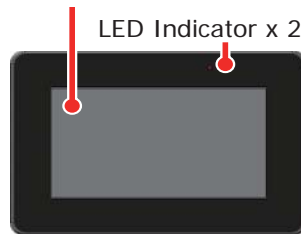

LED Indicator x 2

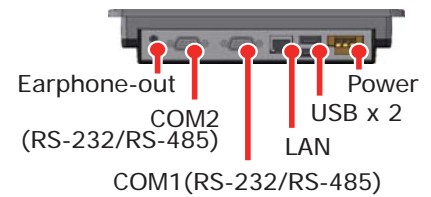
**SV-3201**

8.4" LCD Touch Panel

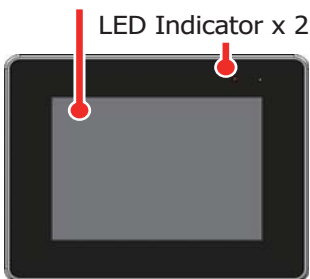

LED Indicator x 2

Console Port (Reserved)



SD Socket

DIP SW.

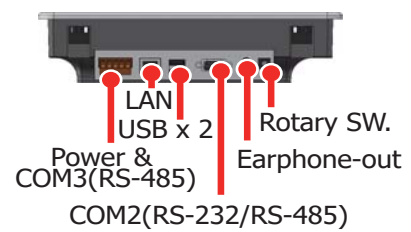
**SV-4201**

SD Socket

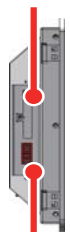

DIP SW.

10" LCD Touch Panel

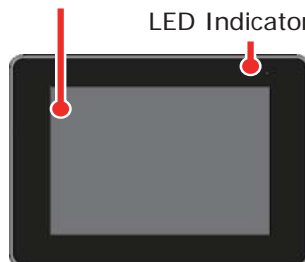

LED Indicator x 2

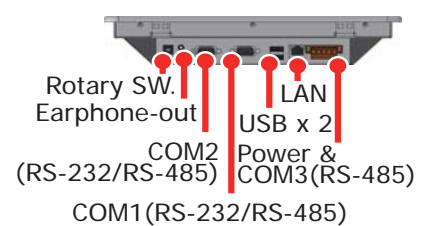

SV-5201

12.1" LCD Touch Panel
LED Indicator x 2

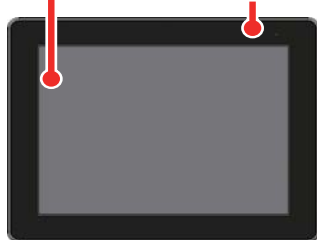

DIP Switch



SD Socket

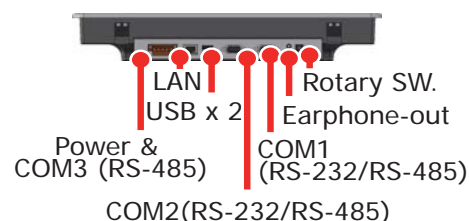

SV-6201

15" LCD Touch Panel
LED Indicator x 2



DIP Switch



SD Socket

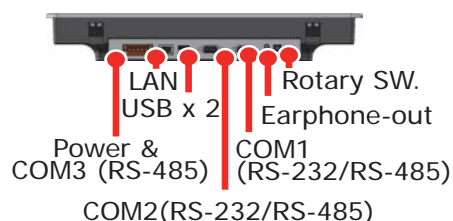

SmartView Selection Guide

SV -

X	X	0	1
LCD Size 2: 7" 3: 8.4" 4: 10.4" 5: 12.1" 6: 15"	CPU Type 2: AM335x	No. of I/O Slot 0: w/o slot	

Ordering Information

SV-2201	7"	SmartView (Linux OS)
SV-3201	8.4"	SmartView (Linux OS)
SV-4201	10.4"	SmartView (Linux OS)
SV-5201	12.1"	SmartView (Linux OS)
SV-6201	15"	SmartView (Linux OS)

Accessories

DIN-KA52F	24 V/1.04 A, 25 W Power Supply with DIN-Rail Mounting
MDR-20-24	24 V/1 A, 24 W Power Supply with DIN-Rail Mounting
CA-0950-3W	5.0 M 3-Pin Male to Female D-sub RS-232 Cable w/Ferrite Core