

TKF-085b-TOUCH-MODUL



FEATURES

- Panel mount version with flat construction
- Integrated capacitive touchpad
- Compact key layout
- Resistant cover membrane
- Embossed keys
- Resistant against dirt, dust and liquids (IP65 front)

TECHNICAL DATA

Number of keys: 85
 Mounting type: front panel with threaded bolts
 Front panel material: FR4 (epoxy resin)
 Keyswitch technology: gold plated domes
 Switching cycles: ca. 1 mill. (per key)
 Operating force: 3 N
 Switch travel: 0.6 mm
 Protection level (max): IP65 (front)
 Interfaces: PS/2; USB
 USB compatibility: complies with USB 2.0

Operating temperature: 0 °C to +70 °C
 Storage temperature: -25 °C to +80 °C
 Dimensions: 365 x 135 x 13.4 mm
 Weight: approx. 350 g

TECHNICAL DATA TOUCHPAD

Operating principle: capacitive
 Resolution: 1400 dpi
 Dimensions: 65 x 49 mm
 USB compatibility: compliant with USB 2.0

Cat.No.	Product description	Interface	Layout
KF02032	TKF-085b-TOUCH-MODUL-USB-DE	USB	German
KF02033	TKF-085b-TOUCH-MODUL-USB-US	USB	US
KF02030	TKF-085b-TOUCH-MODUL-PS/2-DE	PS/2	German
KF02031	TKF-085b-TOUCH-MODUL-PS/2-US	PS/2	US

Other language versions / interfaces / configurations available on request.

Subject to modifications and errors

Additional functions of the touch pad

Your device has a touch pad and it provides the following additional functions:

1. You can adjust the sensitivity level
2. You can reproduce the mouse buttons
3. You can reproduce the scroll wheel
4. You can reproduce holding down the left mouse button and moving it [tap and hold]

1. Adjusting the sensitivity level

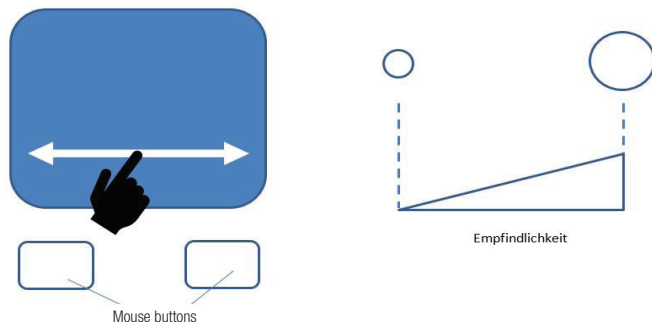

You can adjust the sensitivity level of the touch pad.

When delivered, the sensitivity is set at the lowest level.

You can adjust the sensitivity of the touch pad as follows:

- Press and hold both mouse buttons for approx. 5 sec. → the cursor starts to rotate.
- You can adjust the sensitivity level by moving your fingers across the touch pad horizontally; the level is displayed by the rotation circle of the cursor:
 - Small circle - lower sensitivity
 - Large circle - higher sensitivity
- The cursor stops rotating 5 seconds after you release the mouse buttons and the touch pad is then ready for use.

2. Activating the reproduction of mouse button functions

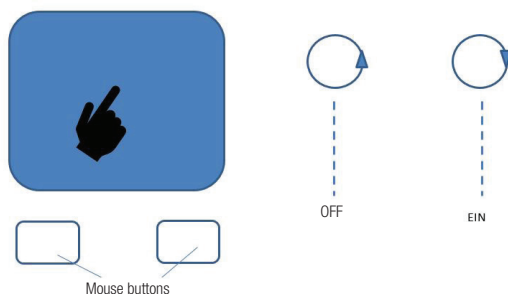

The touch pad can detect a left mouse click or a right mouse click.

- Left mouse click: a short tap on the touch pad with one finger
- Right mouse click: a short tap on the touch pad with two fingers

This function – reproducing the mouse buttons – is active when the unit is delivered and you can turn it on or off as follows:

- Press and hold both mouse buttons for approx. 5 sec. → the cursor starts to rotate
- You can switch on or off the reproduction of mouse button functions by briefly tapping the touch pad and this is displayed by the direction of rotation of the cursor:
 - rotation clockwise – Reproducing the mouse button ON
 - rotation counterclockwise – Reproducing the mouse button OFF
- The cursor stops rotating 5 seconds after you release the mouse buttons; the touch pad is then ready to use.

Additional functions

3. Scroll wheel	Stroke the touch pad with two fingers in a vertical direction
4. Hold down the left mouse button and move [tap and hold]	Tap the touch pad and keep your finger on the touch pad for a short time

TECHNICAL DRAWING (in mm)

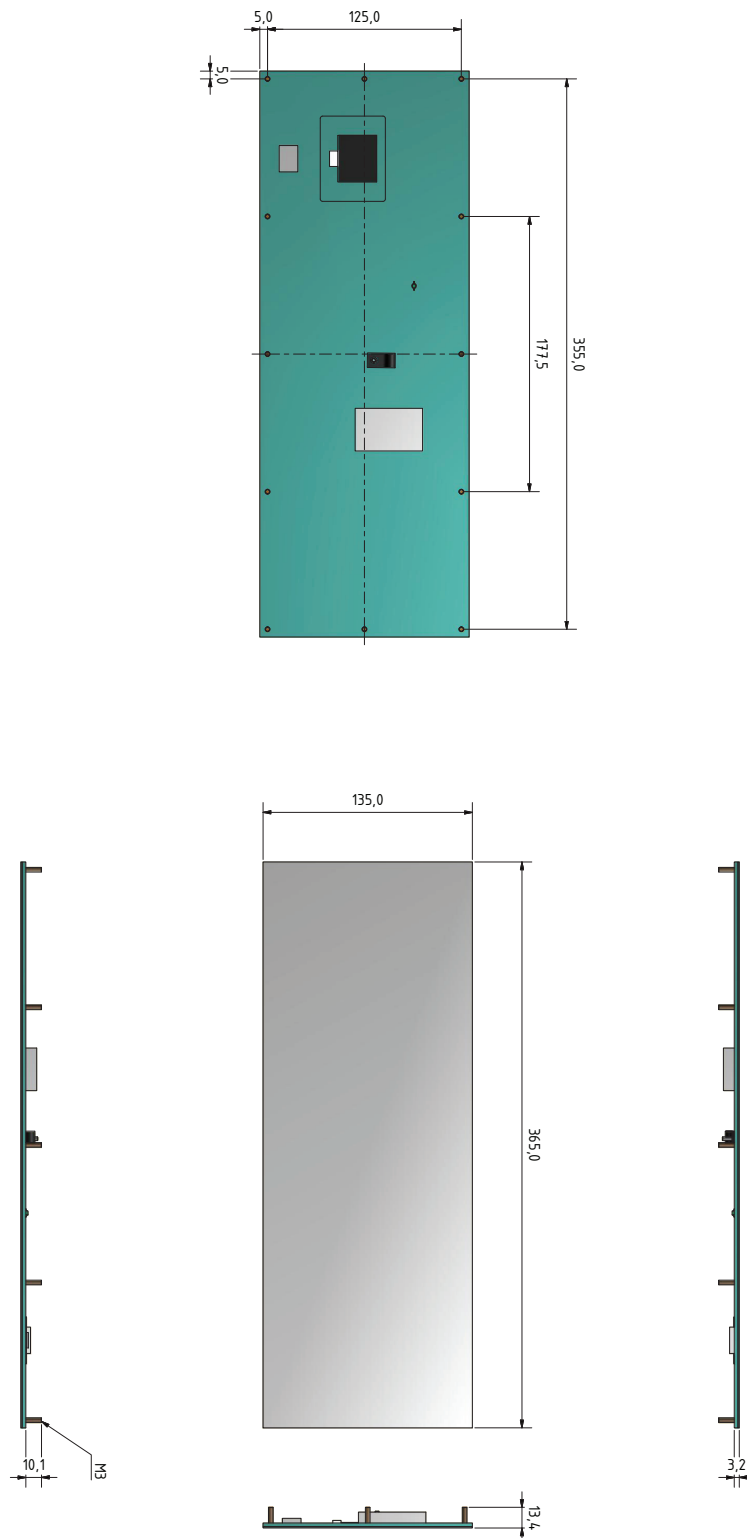

Subject to modifications and errors

GETT Gerätetechnik GmbH

Mittlerer Ring 1 | 08233 Treuen | Germany
Tel: +49 37468 660-0
Fax: +49 37468 660-66
E-Mail: info@gett.de
Internet: www.gett.de

Gett North America LLC

E-Mail: info@gett-na.com
Internet: www.gett-na.com

Gett Asia Ltd.

E-Mail: info@gett-asia.com
Internet: www.gett-asia.com

gett.de
gett-group.com