



IES2100SL Series

DIN-Rail Mounting

5/8/16-Port 100M Unmanaged Industrial Ethernet Switch

- Support 5, 8 or 16 100M copper ports (optional)
- Support storm suppression, flow control, one-key VLAN (5T, 8T), loop detection (5T, 8T), CC-A (PN-16T) and other functions
- Support up to 2048 bytes of Jumbo frame
- Support dual power redundancy, input voltage 12/24/48 VDC (9~60VDC)
- Support -40~75°C wide operating temperature range
- Support IP40 protection grade



Industrial Grade



RPS



Introduction

IES2100SL series are 5/8/16-port 100M unmanaged industrial Ethernet switches. This series provides 4 products and support 100M copper ports. They adopt DIN-Rail mounting to meet the requirements of different application scenes.

DIP switch can implement functions such as device storm suppression, flow control, VLAN, loop detection and CC-A. The input power supply is two independent power supply circuits that can ensure the device's normal operation when one power supply fails. Hardware adopts fanless, low power consumption, wide temperature, and voltage design and has passed rigorous industrial standard tests, which can suit for the industrial scene environment with harsh requirements for EMC. It can be widely used in smart city, safety city, intelligent manufacturing and other industrial fields.

Dimension

Unit: mm

- IES2100SL-5T-2LV

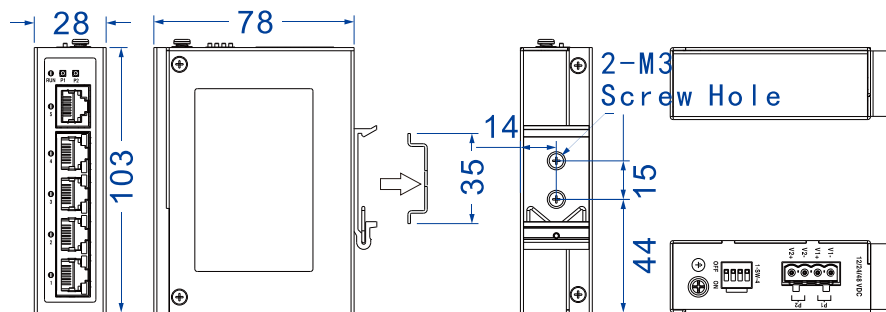

- IES2100SL-8T-2LV

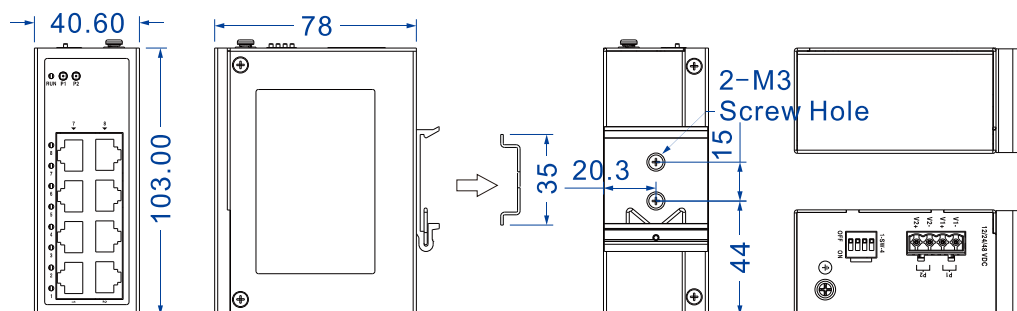

- IES2100SL-16T-2LV, IES2100SL-PN-16T-2LV

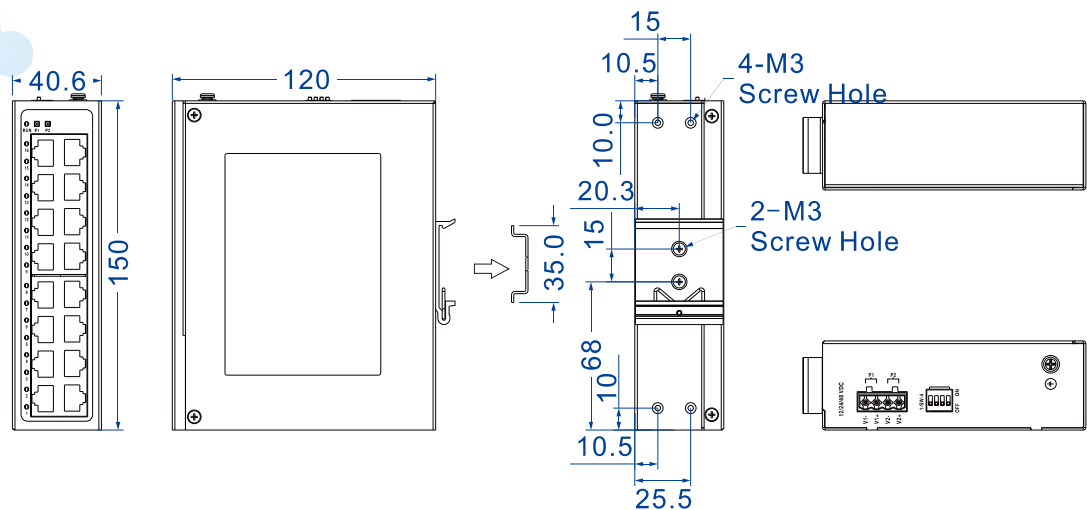

Specification

Standard & Protocol	<p>IEEE 802.3 for 10Base-T IEEE 802.3u for 100Base-TX IEEE 802.3x for Flow Control IEEE 802.1Q for VLAN</p>									
Interface	<p>100M copper port: 10/100Base-T(X) self-adaptive RJ45, full/half duplex mode self-adaption, MDI/MDI-X autotuning</p> <p>DIP switch:</p> <ul style="list-style-type: none"> • IES2100SL-5T-2LV, IES2100SL-8T-2LV: 1-loop detection, 2-storm suppression, 3-VLAN, 4-flow control • IES2100SL-16T-2LV: 1-flow control, 2-storm suppression, 3/4-NC • IES2100SL-PN-16T-2LV: 1-CC-A, 2/3/4-NC 									
Indicator	<p>Power indicator, running indicator, interface indicator</p>									
Switch Property	<p>Transmission mode: store and forward MAC address: 2K (5T/8T), 8K (16T/PN-16T) Backplane bandwidth: 1G (5T), 1.6G (8T) and 3.2G (16T/PN-16T) Switch time delay: <10μs</p>									
Power Supply	<p>12/24/48 VDC (9~60VDC), dual power supply redundancy, using 4-pin 5.08mm pitch terminal blocks, support anti-reverse connection</p>									
Power Consumption	<table border="1"> <thead> <tr> <th style="background-color: #0056b3; color: white;">Available Models</th> <th style="background-color: #0056b3; color: white;">No-load</th> <th style="background-color: #0056b3; color: white;">Full-load</th> </tr> </thead> <tbody> <tr> <td>IES2100SL-5T-2LV</td> <td>0.2W@12VDC</td> <td>0.8W@12VDC</td> </tr> <tr> <td>IES2100SL-8T-2LV</td> <td>0.4W@12VDC</td> <td>3.0W@12VDC</td> </tr> </tbody> </table>	Available Models	No-load	Full-load	IES2100SL-5T-2LV	0.2W@12VDC	0.8W@12VDC	IES2100SL-8T-2LV	0.4W@12VDC	3.0W@12VDC
Available Models	No-load	Full-load								
IES2100SL-5T-2LV	0.2W@12VDC	0.8W@12VDC								
IES2100SL-8T-2LV	0.4W@12VDC	3.0W@12VDC								

IES2100SL-16T-2LV, 0.7W@48VDC 2.9W@48VDC
IES2100SL-PN-16T-2LV

Working Environment	Operating temperature: -40~75°C Storage temperature: -40~85°C Relative humidity: 5%~95% (no condensation)
Physical Characteristic	Housing: IP40 protection, metal Installation: DIN-Rail mounting Dimension (width× height× depth): 28mm×103mm×78mm(5T), 40.6mm×103mm×78mm (8T), 40.6mm×150mm×120mm (16T//PN-16T)
Industrial Standard	IEC 61000-4-2 (ESD, electrostatic discharge), Level 3 <ul style="list-style-type: none">● Contact discharge: ±6kV● Air discharge: ±8kV IEC 61000-4-4 (EFT, electrical fast transient pulses), Level 3 <ul style="list-style-type: none">● Power supply: ±2kV● Copper port: ±2kV IEC 61000-4-5 (Surge), Level 3 <ul style="list-style-type: none">● Power supply: differential mode±1kV, common mode±2kV● Copper port: ±2kV Shock: IEC 60068-2-27 Free fall: IEC 60068-2-32 Vibration: IEC 60068-2-6
Authentication	CE, FCC, RoHS
Warranty	5 years

Ordering Information

Available Models	100M Copper Port	Power Supply
IES2100SL-5T-2LV	5	12/24/48 VDC Dual power supply redundancy
IES2100SL-8T-2LV	8	
IES2100SL-16T-2LV	16	
IES2100SL-PN-16T-2LV	16	



Address: 3/B, Zone 1, Baiwangxin High Technology Industrial Park, Song Bai Road, Nanshan District, Shenzhen, 518108, China

TEL.: +86-755-26702668 ext 835 FAX: +86-755-26703485

E-mail: ics@3onedata.com

Website: www.3onedata.com

◀ [Please scan our QR code for more details](#)

*Product pictures and technical data in this datasheet are only for reference. Updates are subject to change without prior notice. The final interpretation right is reserved by 3onedata.